



THE SHIELD

Professional Excavators L.P. Employee Newsletter

FEBRUARY 2009



PRESIDENTS MESSAGE

RECENT LAYOFFS

It is very important to me to comment on the recent layoffs. During the past 7 months our company has had 2 million dollars of existing work put on hold or cancelled; Luna (ITC), Centuria (Lake Placid) and Strategic on 4th (Clark Builders).

Along with these projects coming to a halt, we have had projects awarded from September 2008 on put on hold or cancelled; Hansen Square (Luxe Developments), Bridges (Apex) and Mission Block (Dominion Construction).

This has had an obvious impact on our work program and revenues. Global economic conditions have reduced the availability of credit or have made these projects not economically viable.

On a brighter note, we have been awarded several projects which will begin in the next few weeks and some of the projects which have been put on hold for one reason or another will resume again.

Tough economic times require tough decisions and we hope that these layoffs are temporary.

Jan Gryckiewicz

VICE PRESIDENT'S MESSAGE

What will 2009 bring? When you watch the news and read the paper, one would think the sky is falling. Our view at Professional Excavators is that now is a good time to expand our horizons. As Jan has told you, we are venturing into the concrete and asphalt sector. We are bringing in qualified tradesmen to help us achieve what we believe our clients want; which is one contractor for all their needs on a job site.

Mr. Roger Rigoni will be joining us Feb. 23 to start ordering materials and setting up a fabrication area in the yard. Roger has 40+ years experience in the concrete business and we welcome him to the Professional Excavators family.

I am excited to be involved in this new venture and I know I can count on all of you for your full support and cooperation.

Ron Claxton

PLEASE NOTE:

It is **MANDATORY** for all employees to have their WHMIS and flagging tickets with them on job sites at all times.

Professional Excavators is arranging FIRST AID training for all employees who are missing their certification.

If you have misplaced your WHMIS or flagging tickets, or require FIRST AID training please contact Lindsay Mason @ (403) 236-5686.

WELCOME!

Starting in the Spring of 2009, Professional Excavators L.P. will be joining the Commercial/ Civil Concrete and Paving sector.

We are pleased to announce that Mr. Kim Wolkowski, C.E.T, GSC, has joined our team. Kim will join our group as a Senior Estimator and Project Coordinator and in conjunction with Ron Claxton; he will head our newly formed Commercial/ Civil Concrete and Paving Business Unit.

Kim has 30 years of experience in both commercial and civil construction. Prior to joining Professional Excavators L.P., Kim was in charge of Pro-Con Road Works Concrete Construction Division, including business development. He also served as the General Manager of Construction Services with Lafarge Canada.

NEW EMPLOYEES:

Roger Rigoni- Concrete Superintendant

Kim Wolkowski- Concrete/ Paving PM

Terry Gugyelka- Paving Superintendant

Thomas LoGullo- Formsetter

Carmine Pascale- Formsetter

William McLean- Concrete Finisher

Michael Rigoni- Concrete Finisher Foreman

Steve Rigoni- Concrete Finisher Foreman

February Birthdays:

- Gurjinder Shergill- February 26

Recently Bid On:

- Signal Hill Retail Infill
- Reimer Trucking Cross Dock Facility
- Okotoks Corporate Center
- Chestermere Boston Pizza
- Cloverdale Cheese Expansion
- Sterling Crane- New Facility
- Retender Aspen Woods Safeway
- Rockyview Hospital- South Addition
- Checker Self Storage
- CIBC Bank- Southcentre
- Louise Station- Site Services
- Backfill Site @ 29th Ave & Centre St NE
- Shell Gas Bar- MacLeod Trail



All our employees must take part in our yearly mandatory drug testing with Verifications Canada.

You will have until April 30th to have the testing completed.

Please contact Lindsay Mason
@ (403) 236-5686 to arrange your appointment.

FYI: Professional Excavators LP has

joined forces with **Merlin Edge Inc.** to create a new and exciting company website. Over the next 6 weeks, we will be working closely with them, in order to present to our clients and employees a professional and creative site.

Our **MISSION** at Professional Excavators L.P. is to lead Calgary's construction industry by:

- Providing core services such as excavation, demolition, water and sewer installation, infrastructure, and site management
- Backing these services with our strength of experience, cooperation, supervision, and project scheduling
- Delivering these services with excellence that is rooted in our corporate values of safety, self-reliance, and honesty
- Celebrating our long-term commitment to this community and all our stakeholders, including our employees, clients and suppliers, by operating with integrity and honour

SAFETY BULLETIN

DRUGS, ALCOHOL & CONSTRUCTION

Here are a few things to remember about substance abuse.

- It has **NO** place on a construction site.
- It leads to accidents, injuries, and even deaths.
- It reduces quality, efficiency, and productivity.
- It leads to arguments-both at work and at home.
- It harms your health and impairs your skills.
- It costs lives, time, and money.

Alcohol is one of the most commonly abused drugs. Many of us have an occasional drink, but we have to be responsible and make sure that our drinking doesn't jeopardize others. You should also be careful not to become dependent on having that beer on the way home. Other drugs of choice include cocaine, methamphetamines, and marijuana; even some prescription drugs are abused. Other than as prescribed by your doctor, using any drug on the job is grounds for termination.

Construction work has more than enough risks without having to worry about a fellow employee who is high on drugs, too. Substance abuse is widespread in today's society; users can be found everywhere. For example, you could find yourself working with a crane operator who is also a drug abuser. What could happen if he or she were making a 100 ton lift, but was not in complete control?

If you know someone who has a problem encourage him or her to seek professional help. If you have a problem yourself, get the help you need. Your MERIT membership includes access to an employee and family assistance plan. Consult your Membership documentation for contact information.

THE ESSENTIALS OF FIRST AID

First aid is not an exact science. The essentials for the saving of life are not altered by variations in existing conditions. The order of treatment varies greatly and is determined by physical conditions as well as the nature of the injuries.

When the need for emergency treatment arises, follow these basic rules:

1. Avoid excitement or panic. **KEEP CALM!** (Check your emotions at the door, work from knowledge, not emotional stress.)
2. Know who the responsible first aid trained personnel are and how to contact them.
3. If immediate action is needed to save a life (artificial respiration, control of severe bleeding, etc.) give the proper treatment without delay.
4. Never move a badly injured person unless it is necessary to get them to fresh air, or to protect them from further harm.
5. Make a careful examination of the victim.
6. Seek medical attention immediately. Notify the police, fire agency or send for an ambulance if needed

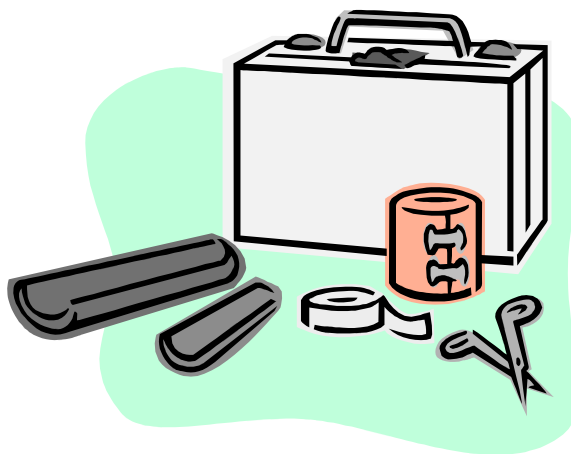

SAFE WORK PROCEDURE HOUSEKEEPING

PURPOSE:

The purpose of this practice is to establish the general requirements for the maintenance of good housekeeping on the Company projects.

GENERAL:

Good housekeeping is the key to a safe and productive project and shall be maintained at all times. The Company reserves the right to maintain good housekeeping by cleaning up contractor areas as required and back-charging for the service.

Waste receptacles shall be provided through the work area. Waste shall be kept segregated as required.

Keep stairways, access ways and ladders clear of materials at all times. Clean up work areas as work progresses. Do not wait until the end of the shift.

Do not throw garbage or material from elevations. Lower in containers or install chutes to containers below.

Ensure materials are well secured especially at elevations to avoid movement during windy conditions.

Areas in the proximity of emergency equipment such as fire extinguishers, hoses, and emergency personal protective equipment shall be kept clear at all times.

Hoses, cables and cords shall be placed in an orderly manner to avoid tripping hazards. Hoses, cords and cables shall be suspended above areas where they may be exposed to damage and where practical. Cables shall be protected from mechanical damage, where applicable, if cables cannot be suspended.

Oily rags shall be disposed of in metal cans and not placed with other garbage.

AWARDED:

Foothills Medical Centre
Rough Grading & Demolition

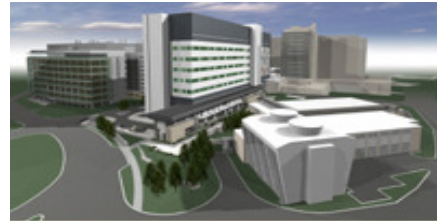

Foothills Medical Centre
1403 - 29 Street NW
Calgary, Alberta

Work is proceeding on the new eight-storey tower on the northwest corner of the **Foothills Medical Centre** site recently named after well-known local philanthropist Bud McCaig. The building will be known as the **JR (Bud) McCaig Tower**. The new building will include:

- Eight new operating rooms
- Thirty-six bed Intensive Care Unit
- Ninety-three inpatient beds
- Twenty-one short-stay beds
- Diagnostic Imaging
- Southern Alberta Tissue Program
- Calgary Laboratory Services
- Shelled space to build 16 more operating rooms in the future
- Expanded and renovated Emergency Department in main building
- Musculoskeletal (MSK) Clinic
- Surgical Processing
- Admitting
- Interchange over 16 Avenue and 32 Street for better access to the site (Alberta government and the City of Calgary project)
- Ring road for easier access within the site

SAFETY NEWS

Professional Excavators LP will be running an external safety audit through the Alberta Construction Safety Association, and it will be completed no later than May 1st

As of May 1st, 2009, Gordon Christensen will be taking over as Professional Excavator's Safety Officer.